

Flexible COB LED Strip With Yellow Glue (FCOBY-240LEDs Series)

Ref.: BL-FCOBY-240-24V-10mm-XXK

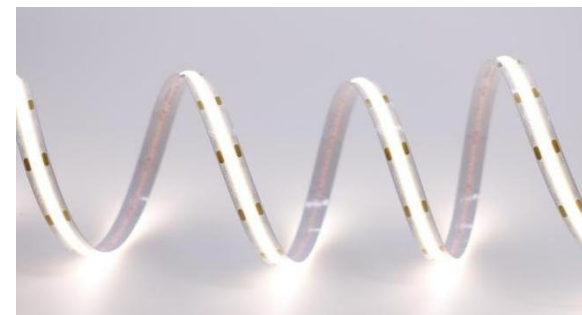
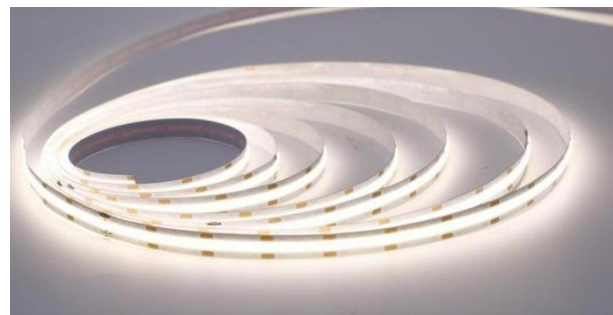

产品名称 Model No	FCOB LED STRIP WIT YELLOW GLUE
工作电压 Voltage	12V \ 24V
灯珠数量 Led/m	480Leds/M
显色指数 CRI	Ra>90
线路板宽 PCB Width	8mm、10mm
发光颜色 Color	2700K 3000K 4000K 6000K
防水等级 IP Rate	IP20、IP67

Flexible COB LED Strip With Yellow Glue (FCOBY-240LEDs Series)

产品名称 Product description:

- FCOB LED STRIP (Flexible COB LED STRIP)

产品特点 Characteristics:

- ▶ Adopt brand LED chip, high brightness, low light decay, lifespan more than 25000 hours
- ▶ Color:2700K、3000K、4000K、6000K ;
- ▶ All of materials are accord with RoHS standards
- ▶ Easy to install and preserve; can be bent freely; with 3M adhesive tape on the backside
- ▶ High color efficiency, uniform illumination
- ▶ beam angle 180° ,
- ▶ IP20--- non-waterproof

防水等级 IP



IP 20



IP 67

应用范围 Application:

- ▶ Letter signage backlight
- ▶ Building Decoration
- ▶ Auditorium walkway lighting
- ▶ Advertising signs, light box lighting
- ▶ Landscape decoration



Flexible COB LED Strip With Yellow Glue (FCOBY-240LEDs Series)

电性光电特性 (TA=25°C) Electrical-optical characteristics:

Model-480LED/M 8mm	Color	LEDs Qty./M	LEDs Type	Beam angle(°)	Voltage (DC)	RA	Power (W/M)	LM/W (avg.)	LM/M	Min. cut/mm
BL-FCOBY-12V-240-8mm	2700K	480	FCOB	180	12V	Ra>90	9.6W±10 %	80	700	25
	3000K							85	700	25
	4000K							90	750	25
	6000K							95	800	25
BL-FCOBY-24V-240-8mm	2700K	480	FCOB	180	24V	Ra>90	9.6W±10 %	80	800	50
	3000K							85	850	50
	4000K							90	900	50
	6000K							95	1050	50



Flexible COB LED Strip With Yellow Glue (FCOBY-240LEDs Series)

Model-480LED/M 10mm	Color	LEDs Qty./M	LEDs Type	Beam angle(°)	Voltage (DC)	RA	Power (W/M)	LM/W (avg.)	LM/M	Min. cut/mm
BL-FCOBY-12V-240-10mm	2700K	480	FCOB	180	12V	Ra>90	13W±10%	80	900	25
	3000K							85	950	25
	4000K							90	1000	25
	6000K							95	1100	25
BL-FCOBY-24V-240-10mm	2700K	480	FCOB	180	24V	Ra>90	13W±10%	80	900	50
	3000K							85	950	50
	4000K							90	1050	50
	6000K							95	1200	50

注意事项 Attention:

- 1, Electrical parameters are standard one meter testing
- 2, error allow 10%
- 3, IP protection process will lead to changes in size, color temperature and luminous flux

Flexible COB LED Strip With Yellow Glue (FCOBY-240LEDs Series)

产品尺寸 Dimension:

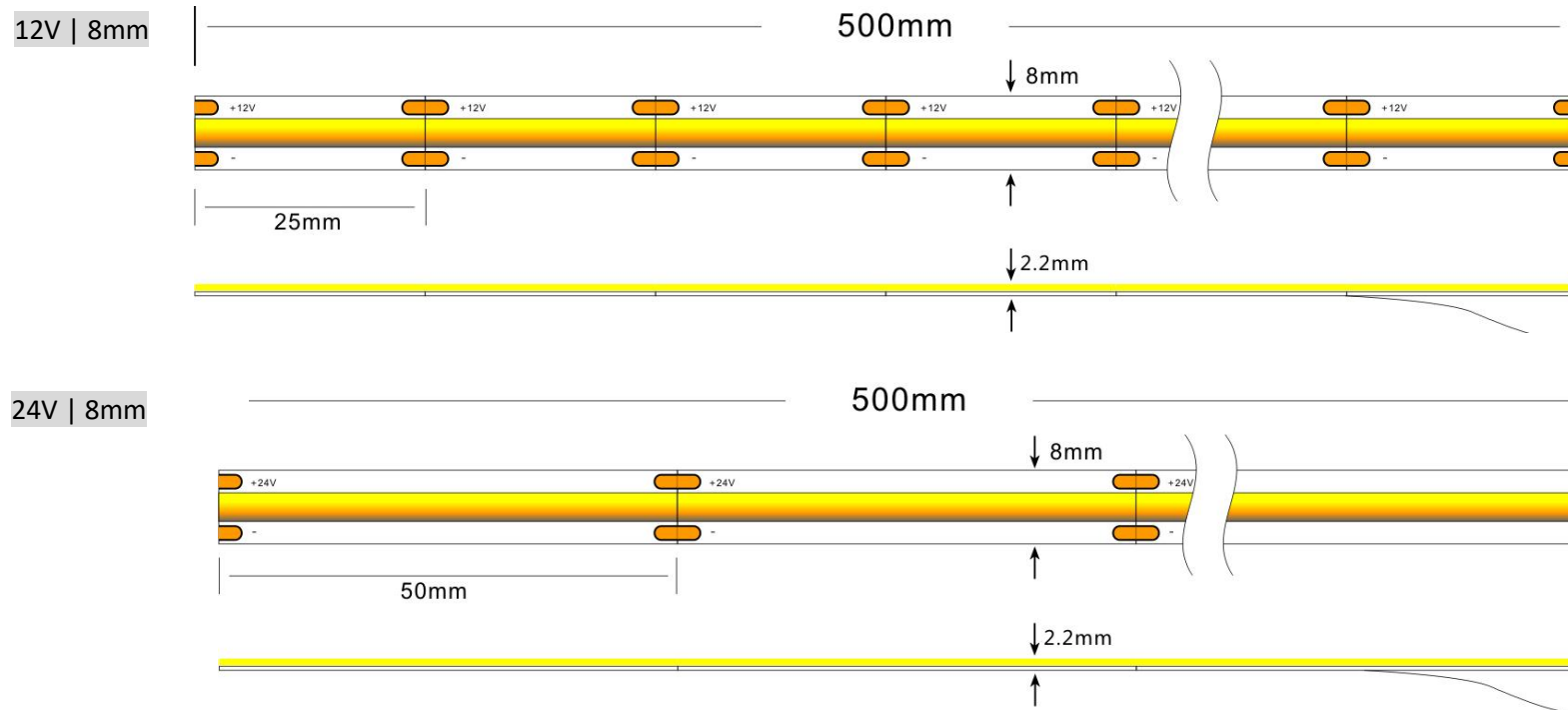

Flexible COB LED Strip With Yellow Glue (FCOBY-240LEDs Series)

12V | 10mm

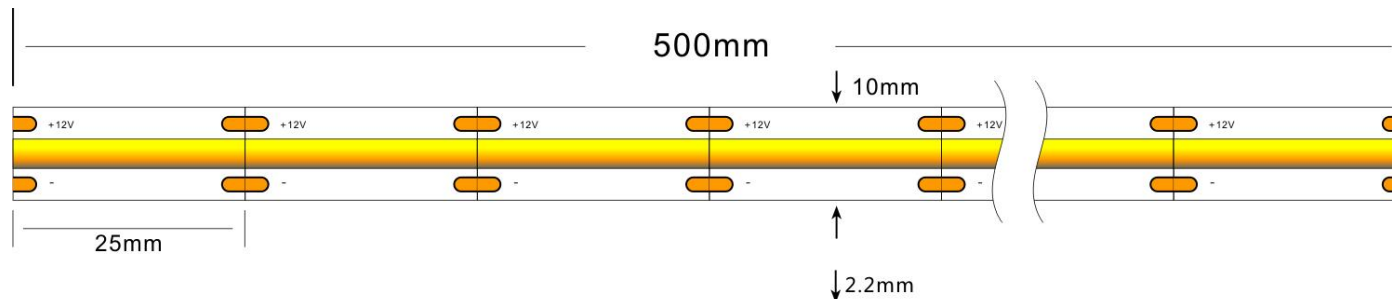

24V | 10mm

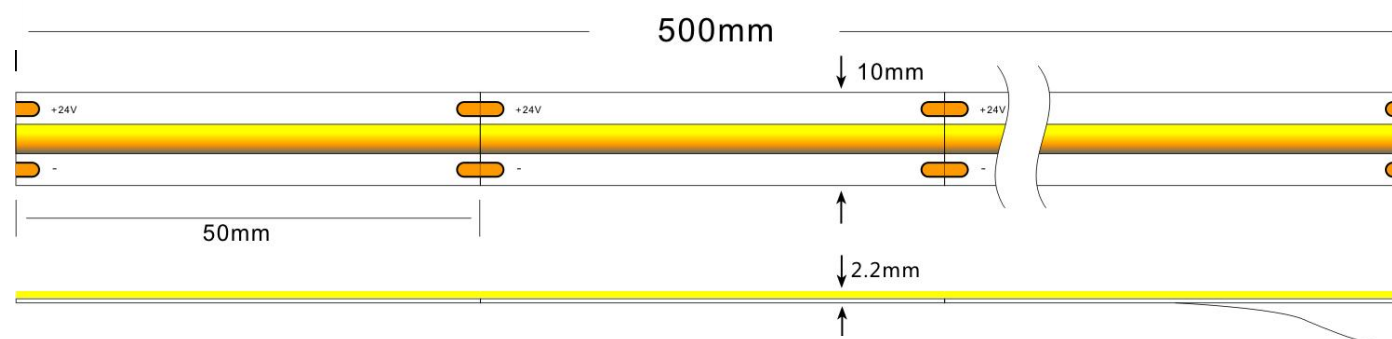

发光角度 Beam angle:

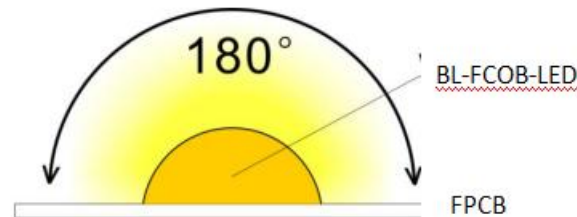

Flexible COB LED Strip With Yellow Glue (FCOBY-240LEDs Series)

绝对最大额定值 (TA=25°C) Absolute maximum ratings:

参数parameter	符号symbol	最大额定值Max Value	单位Unit
额定电压Forward voltage	VF	12/24	V
抗静电能力Antistatic	ESD	2000	V
工作温度Working temperature	Topr	-20 – 80	°C
存储温度storage temperature	Tstg	-40 – 100	°C

可靠性测试项目及测试条件 Reliability Test Items and Conditions:

No.	Test Item 测试项目	Test Conditions 测试条件	Note 频次	Number of Damaged 合格破坏数
01	Thermal Shock 冷热冲击测试	-25°C 15min ↑↓ 100°C 15min	300 cycle	0/22
02	Life Test 常温寿命测试	T _a =25°C 额定电压	1000 hrs	0/22
03	Temperature Humidity Storage 恒温恒湿贮藏测试	T _a =85°C RH=85%	1000 hrs	0/22

Flexible COB LED Strip With Yellow Glue (FCOBY-240LEDs Series)

应用说明 Connection diagram:

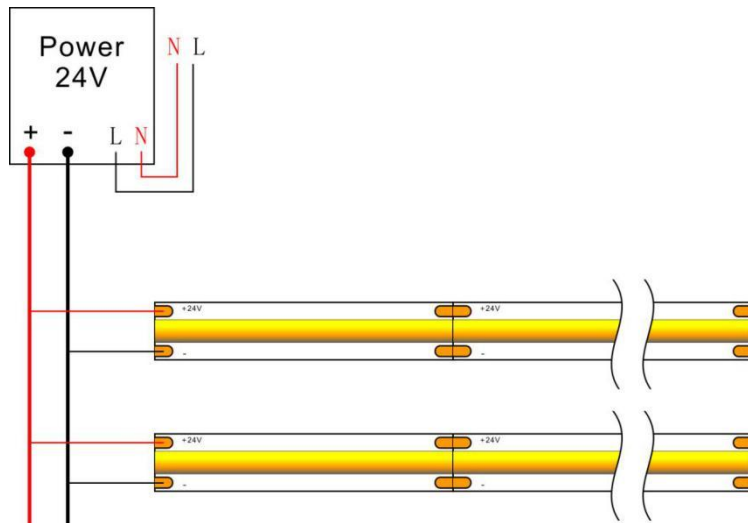

Flexible COB LED Strip With Yellow Glue (FCOBY-240LEDs Series)

产品配件 Accessories:

免焊连接器 (Soldering-free connector)

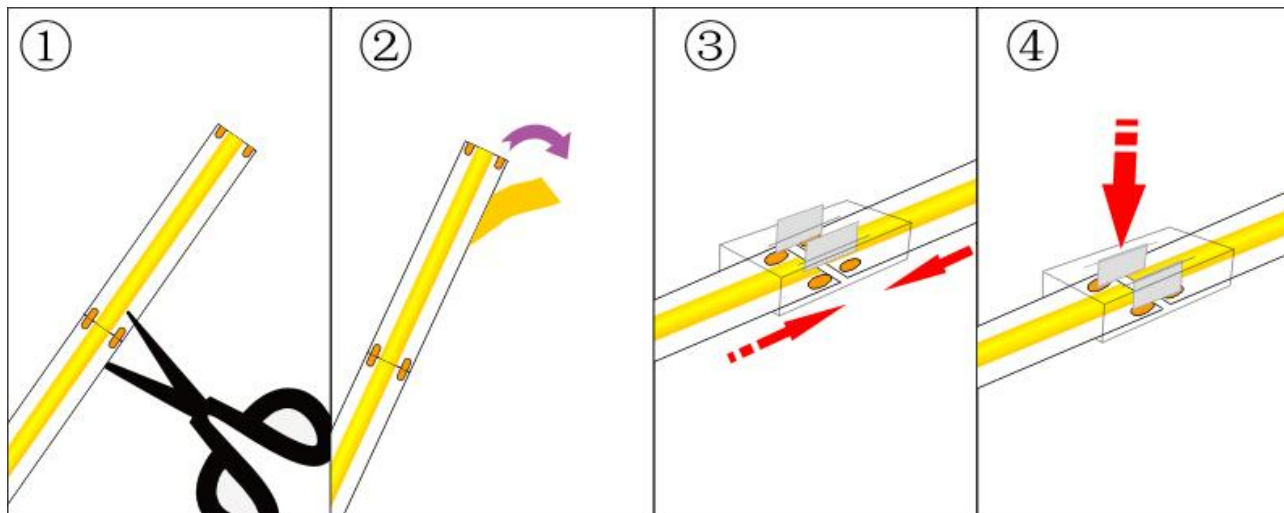
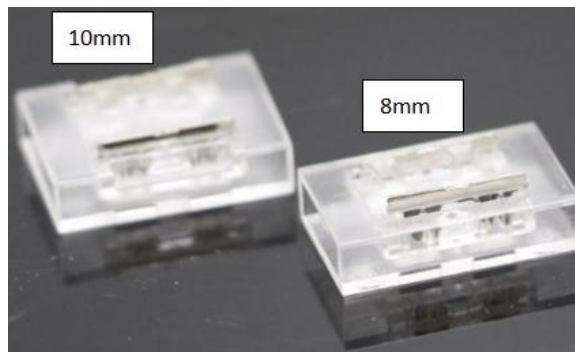



Bright-Land Enterprises Inc., Limited

金迪企业集团有限公司

深圳市金迪亮光电有限公司

3/ F, Bldg.1, No. 18 Louyi Gongliu Road, Loucun,
Guangming New District, Shenzhen 518106, China

Tel: 86-755-29080406

Mobile: +86-13798362897

info@bright-land.com

info@led-tronic.com

Http://www.bright-land.com

Http://www.led-tronic.com

Product Data Sheet Rev: 4.0

Flexible COB LED Strip With Yellow Glue (FCOBY-240LEDs Series)

安装说明 Installation instruction:

- ❖ 1. Please choose correct power supply for led strips. The total power of the led strip is about 80% of the power supply, and it cannot be fully loaded to ensure that the power supply works at the correct and stable voltage.
- ❖ 2. We suggest 5 meters/roll for the led strip.If it is over 5 meters length, the brightness of LED will vary greatly.If the customer can accept the case, length can be made over 5 meters/roll.
- ❖ 3. Adhesive tape on the back side of the strip,with its superior adhesive and weather resistance, and can be connected to any transparent glass, metal and plastic surface. But on some certain surfaces, such as cloth, wood, will affect its function and durability.Please test the adhesion of the led strip before installation.
- ❖ 4. Please pay special attention to the minimum bending diameter of the led strip is 60mm, so as to avoid direct or indirect damage to FPC and components on FPC, which may lead to damages of the strip .
- ❖ 5. In order to ensure waterproof and anti-corrosive function , after the power line is screwed into the connector, it is recommended to inject the connector with a single component of silica gel (or neutral glass glue, or waterproof grease) and cover the exposed copper wire of the power line for protection.
- ❖ 6. The non-waterproof led strip shall not be completely exposed for outdoor use. Do not touch or install the strip when it is charged.
- ❖ 7.It is recommended to use switch power supply that has passed relevant safety regulations (with short circuit protection, over voltage protection and over current protection)